

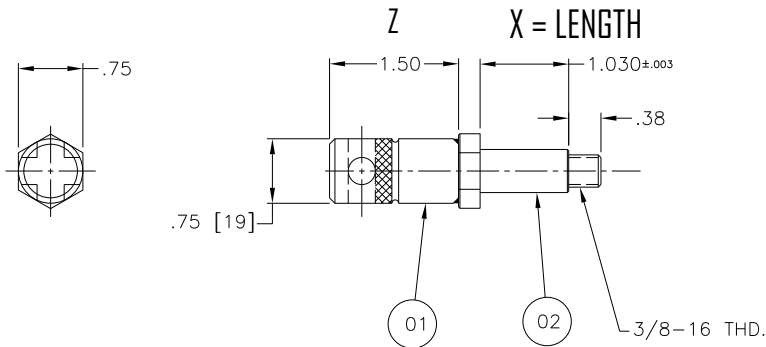

EXAMPLE

Click for CAD Files
.3DWG / .STP



ORDERING INFO FOR OTHER SIZES

EI-831-150-310

DIM. X
SCREW CALLOUT

DIM. Z

NOTE:

DIMS IN [] ARE METRIC

(B) DETAILS 01 & 02 TO BE CONCENTRIC WITHIN .02

FINISH: NITROWEAR

| Z DIM. | KNOB DIA. | X SOC. HD. SCREW SIZE | SCREW CALLOUT |
|------------|-----------------|-----------------------|---------------|
| 019 (3/4) | 3/4 (19.0) DIA. | 1/4 - 20 | 1 |
| 025 (1.0) | 3/4 (19.0) DIA. | 5/16 - 18 | 2 |
| 038 (1.50) | 3/4 (19.0) DIA. | 3/8 - 16 | 3 |
| 050 (2.0) | 3/4 (19.0) DIA. | 1/2 - 13 | 4 |

IF CAD DRAWN, MANUAL CHANGES ARE PROHIBITED

UNLESS OTHERWISE SPECIFIED:

.02 RAD. MAX. ON ALL INSIDE CORNERS

REMOVE ALL BURRS AND BREAK SHARP EDGES

CHAMFER ALL TAPPED HOLES 45° TO .03 OVER TAP SIZE

| GEOMETRIC DRAWING SYMBOLS | | | |
|---------------------------|----------------------------------|--|--------------------------|
| | FLAT | | PROFILE OF A SURFACE |
| | STRAIGHT | | TRUE POSITION |
| | ANGULAR | | SYMMETRICAL |
| | SQUARE | | ROUND |
| | PARALLEL | | TOTAL RUNOUT |
| | ROUND | | CYLINDRICAL |
| | CYLINDRICAL | | CONCENTRIC |
| | CONCENTRIC | | PROFILE OF A LINE |
| | MAXIMUM MATERIAL CONDITION (MMC) | | BASIC DIM. |
| | REGARDLESS OF FEATURE SIZE (RFS) | | PROJECTED TOLERANCE ZONE |

INCH

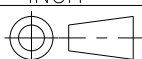

3RD ANGLE PROJECTION

DO NOT SCALE

MACHINING TOLERANCE INCH

2 PLACE DEC. ±.010
3 PLACE DEC. ±.005
4 PLACE DEC. ±.0005



7200 MILLER DR.
WARREN, MI. 48092

TITLE SCREW DOWEL KNOB ASSEMBLY

PART NO. EI-831-XXX-XXX

DRAWN BY: GREG

DATE: 06SEP01

SCALE FULL

SHT 02 OF 02

CHK'D BY: G.A.

DATE: 06SEP01

DWG. NO.

E-831.150.001

APPR'D BY: G.L.A

DATE: 22OCT01